

RDG110U

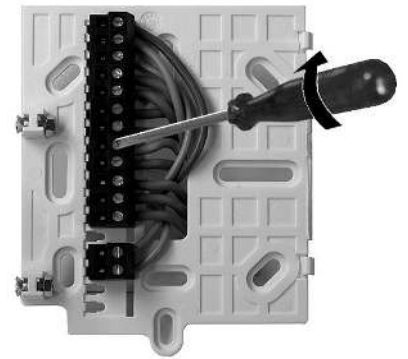

Max. 1 x 2.5 mm² (1 x 14 gauge)
Max. 2 x 1.5 mm² (2 x 16 gauge)

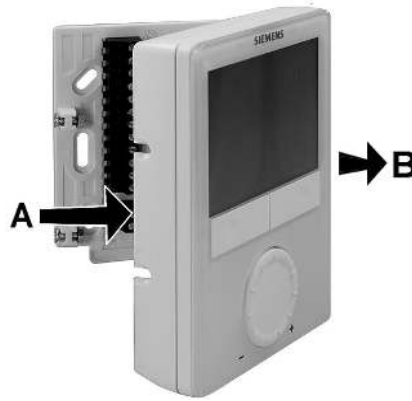
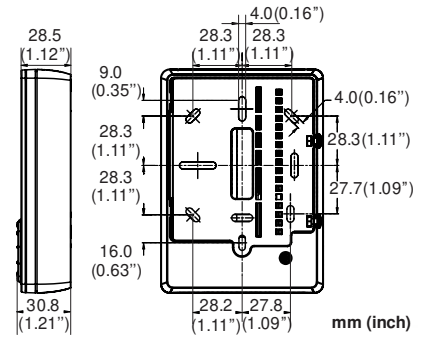
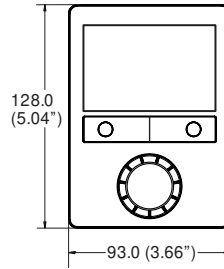
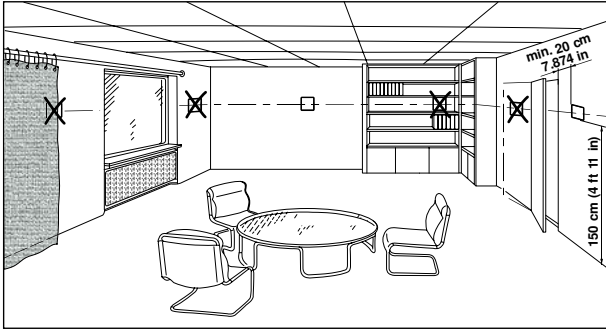

Max. 80 m (262 feet)

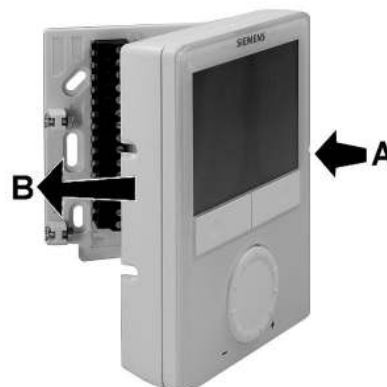
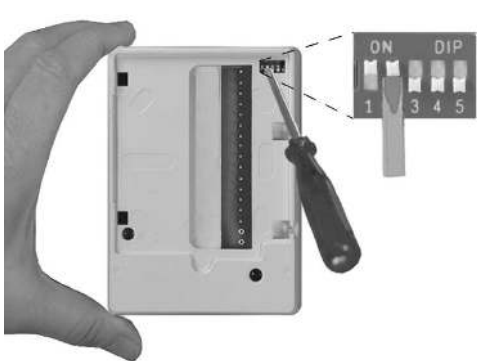
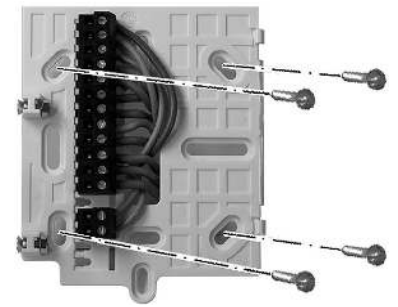
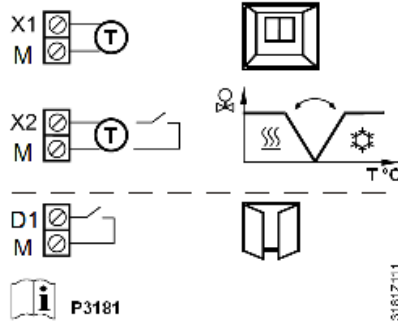

AC 24 V

Max. 10 A

For US installations, use Class 2 rated power supplies.
For other installations, use circuit breakers with rated current of no more than 10 A.

V1, C1	Y11	Y11
1 2-pipe		

1) 1 ... 5

2)

3)

4) G, G0 / 24 VAC

5)

6) P01... Pn

AC 24 V

Max. 10 A

For US installations, use Class 2 rated power supplies.
For other installations, use circuit breakers with rated current of no more than 10 A.

V1	V2	Y11	Y21
C1	U2		
RV	C1		
Y11	Y21		
Y11	Y21	Y12/Y22 Y11/Y21	

2) 2-pipe & el. heater

3) 2-pipe & radiator

4) 4-pipe

5) 2-stage

i → **P3181**

P01=0

P01=1

P01=2

P01=3

P01=4

	en	de	fr	it	es	cs	tr
1	2-pipe fan coil	2-Rohr Ventilator-konvektor	Ventiloconvecteur 2 tubes	Fan coil 2 tubi	Fancoil a dos tubos	2-trubkový fan-coil	2 borulu fan coil
2	2-pipe & el. heater	2-Rohranwendung & Elektroheizer	Application 2 tubes & batterie électrique	Fan coil 2 tubi con batteria elettrica di riscaldamento	2 tubos & batería eléctrica	2-trubkový fan-coil & el. ohřev	2 borulu& elk. Isıtıcı
3	2-pipe & radiator	2-Rohranwendung & Radiatorventil	Application 2 tubes & vanne thermostatique	Fan coil 2 tubi e radiatore	2 tubos & rad	2-trubkový fan-coil & radiátor	2 borulu& radyatör
4	4-pipe fan coil	4-Rohr Ventilator-konvektor	Ventiloconvecteur 4 tubes	Fan coil 4 tubi	Fancoil a 4 tubos	4-trubkový fan-coil	4 borulu fan coil
5	2-stage	2-Stufen-Anwendung	Application à 2 étages	2 stadi	2 etapas	2-stupňový	2 kademe